



Our Kits Include...

Do It Yourself Hardtop Screen Enclosure

SHEDS



SCREEN ROOMS



AWNINGS



**SPECIALTY
ITEMS**



We will gladly supply the serious customer with a quotation under the following guidelines...

Our pre-engineered kits are put together to conform to 2006 International Building Code standards. We will not help our customers take short cuts. For your safety and insurance purposes we will need the following information before considering your request for quotation...

1. **You will need to obtain, from your local building department**, a "pounds per square foot" load requirement as well as a "miles per hour" wind load requirement. This is so that the required thickness of the roof can be assessed.

**Ideally we will require a drawing or picture of your application (see below)

2. For wall attached systems we will need a back wall height measurement - how high on your house wall will you be attaching your patio cover?
3. You will need to give us your desired projection and width
4. We will need to know whether you require a bottom kick-plate (none, 18" or 24").
5. Finally indicate exactly where you would like to have your door placement relative to the house wall or to a front corner.

SAMPLE DRAWING

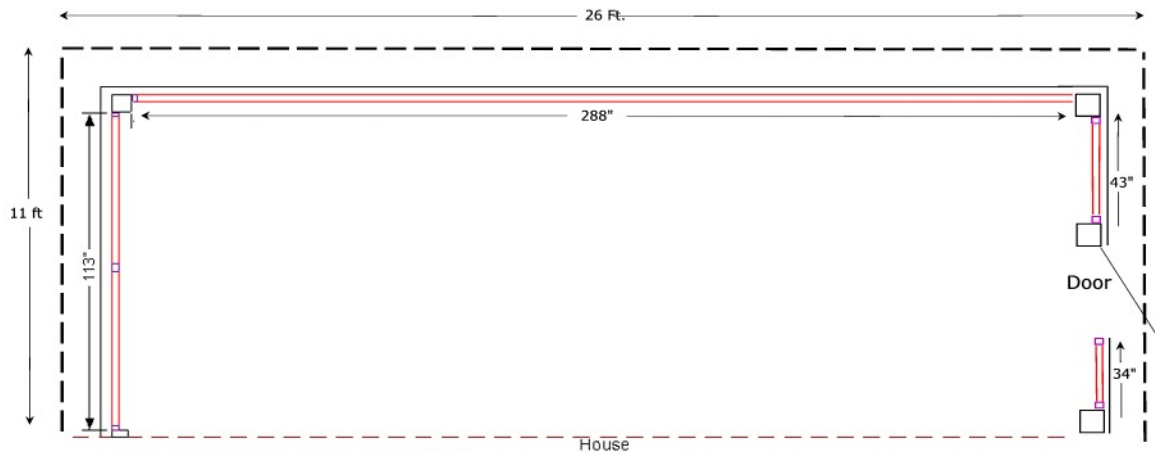

- The dotted line indicates roof line - 11ft dimension = projection / 26 ft dimension = width
- Red lines indicate the screen room walls

We are available by telephone or by email to answer questions on any of our Do-It-Yourself Home Improvement kits. We will guide you in selecting the proper kit, in the proper size that will work with your home. We are experts in kit assembly and can answer your questions BEFORE you make a decision to buy. **Call us for FREE advice with No obligation at (800) 922-4760.**

Best Wishes,

Bob, Shawn, Glenn

The Team